

CE

**KROFtools**<sup>®</sup>  
PROFESSIONAL TOOLS

**2 TON LOW PROFILE HIDRAULIC JACK**  
**REF.: 4813**



**Operating manual and instructions**  
**General information**

Name:	
Address:	

Model:	
--------	--



DECLARATION  
OF CONFORMITY



We:

KROFTOOLS  
Parque Industrial da Pousa  
Rua da Devesa, n.º 8  
4755-307 Martim,  
Barcelos

Declare under our sole responsibility that the product:

Part Number: 4813  
Description: 2TON LOW PROFILE HIDRAULIC JACK  
Serial No:-

To which this declaration relates is in conformity with the following directive (s):

2006/42/EC, referred to as the Machinery Directive.

Issue Date: - 13/06/2024

A handwritten signature in black ink, appearing to read 'José Bárbara'.

José Bárbara  
CEO

**General Information:**

Only authorized persons should operate the jack after carefully reading and understanding the contents of this manual.

Do not modify the jack in anyway.

The manufacturer accepts no responsibility for the improper use of the jack.

**Storage conditions**

It is forbidden to put it in closed space with humid environment for a long time

**Dimensions, masses, position of centre(s) of gravity**

Model NO.	Net weight for jack's body (box 1)	Gross weight for jack's body(box 1)	Dimension for jack's handle
4813	42.20kgs	44.40kgs	107.6x40.1x18.2CM

**Safety Instructions:**

1. Lifting Device only, not for supporting the load. After lifting, support the vehicle with rated jack stands before working.
2. Never exceed the rated capacity of the jack.
3. Use only on hard, level ground. Use chocks as appropriate.
4. Ensure there are no persons inside the vehicle to be lifted before operating the jack.
5. Never work under a raised vehicle without previously supporting it with jack stands.

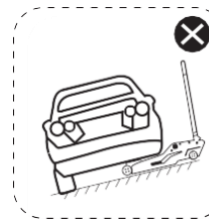
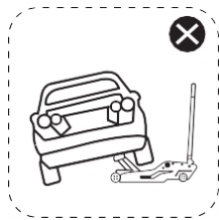
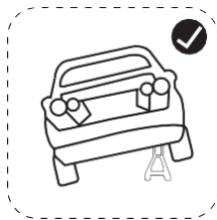
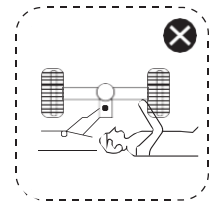
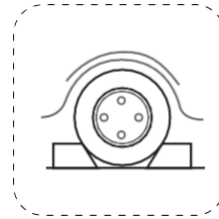
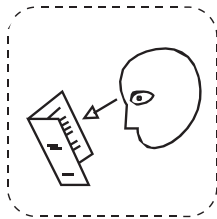

6. Never place any portion of your body under the vehicle when lifting or lowering.
7. Refer to the vehicle manufacturer's owner's manual to locate approved lifting points on the vehicle. Center jack saddle under lift point.
8. If the jack functions irregularly, discontinue use until professionally inspected and repaired.

**Specifications:**

Capacity	Min. height	Max. height	Jack length	Handle length
2T	75mm	530mm	964mm	1100mm

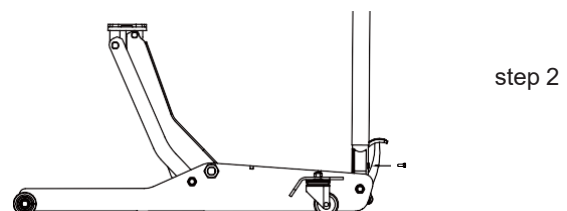
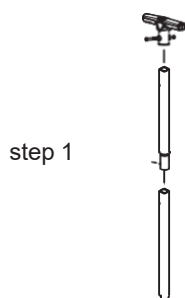

**Assembly:**

1. Assemble the 2 piece with bolt and fixed T shape handle with screw supplied.
2. Insert handle into the handle socket. Tighten the bolt on handle socket to prevent accidental removal of handle while in use.

**Lifting:**

1. Prior to operating the jack, remove any accumulated air from the system below: - Pull the handle and turn it counterclockwise whilst held in this position, pump the jack several times to ensure internal lubrication and bleed the accumulated air from the system.
2. Refer to the vehicle manufacturer owner's manual to locate approved lifting points on the vehicle. Center jack saddle under lift point.
3. This jack are fitted with a foot pedal that gives a faster approach to the load.
4. Pump handle full stroke until load reaches desired height.
5. Transfer the load to appropriately rated jack stands.

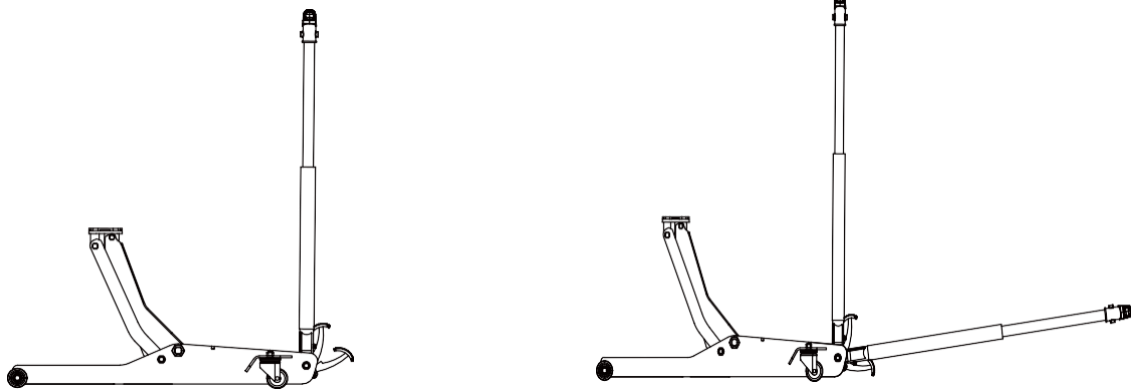
**Lowering:**

1. Raise the vehicle and clear the jack stands.
2. Pull up the handle then turn the handle counterclockwise. the handle is self-return (dead-man principle), you need to hold the handle until the jack back to the initial position.

**Maintenance:**

1. Both the maintenance and repair of the jack may only be performed by qualified professionals.
2. Only original spare parts should be used.
3. When not in use, store the jack with saddle fully lowered. Keep the jack in a clean, dry place and reach out of children.
4. If the oil level needs to be checked or refilled, remove the filler plug and drain its contents into a container. Make sure that no dirt enters with the new oil.
5. Too much oil will prevent saddle from lowering completely. Not enough oil and saddle will not be able to rise to full height.
6. Do not use brake fluid, turbine oil, transmission fluid, motor oil or glycerin. Improper fluid can cause premature failure of the jack and the potential for sudden and immediate loss of load. Premium hydraulic jack oil is recommended.

