

**KROFtools**<sup>®</sup>  
PROFESSIONAL TOOLS

**TIMING TOOL PSA GROUP  
REF 1516**





**Important**

Please read these instructions carefully. Note the safe operational requirements, warnings and cautions. Use the product correctly and with care for the purpose for which it is intended. Failure to do so may cause damage and/or personal injury and will invalidate the warranty. Please keep instructions safe for future use

**Description:** This tool set provides correct engine timing while changing the timing belt

**1- Safety instructions**

WARNING! Ensure Health and Safety, local authority and general workshop practice regulations are adhered to when using tools. DO NOT use tools if damaged.

Maintain tools in good and clean condition for best and safest performance.

Ensure that a vehicle which has been jacked up is adequately supported with axle stands.

Wear approved eye protection. A full range of personal safety equipment is available from your dealer.

Wear suitable clothing to avoid snagging. DO NOT wear jewellery and tie back long hair.

DO NOT attempt to start engine or move vehicle whilst in gear with timing devices fitted.

Always display warning notification on steering wheel when timing engine components.

Account for all tools, locking bolts, pins and parts being used and do not leave them in or near the engine.

WARNING! Incorrect camshaft timing can result in contact between valve head and piston crown causing damage to the engine.

IMPORTANT: Always refer to the vehicle manufacturer's service instructions, or a proprietary manual, to establish the current procedure and data

**2- Applications**

**Models:**

Fiat/Lancia : Ulysse, Scudo, Ducato, Zeta, Phedra

Ford : Fiesta, Fusion, Focus, Focus C-Max

Citroën : C15, C1, C2, C3 Pluriel, C4, C4 Picasso, C5, C6, C8, DS3, DS4, DS5, Xantia, Xsara, Xsara Picasso, Evasion, Berlingo, Jumpy, Jumper, Saxo, ZX, XM, Evasion, AX

Peugeot : 107, 1007, 206 cc, 207, 208, 306, 307 cc, 308, 406, 407, 508, 607, 806, 807, Partner, Expert, Boxer, 206, 106, 605, 205, 405

**Engines:**

Fiat/Lancia : 2.0-2.2 JTD

Ford : 1.4 -1.6 Duratorq TDCI

PSA : 1.0-1.1-1.4-1.6-1.6 16V-1.4 -1.6 HDI-1.8-1.8 16V-2.0-2.0 turbo-1.9 D-2.0 HDI-2.2 HDI-1.8 16V-2.0 16V

**Codes:**

Fiat/Lancia : DW10ATED (RHT/RHV/RHW/RHX/RHZ), DW12TED4 (4HW) Ford : F6JA, F6JB, F6JC, G8DA, G8DB, HHDA, HHDB, HHJA, HHJB

PSA : TU9 (CDY/CDZ), TU1 (HDY/HDZ/HFX/HFY/HFZ), TU3 (KDX/KDY/KDZ/KFX/KFZ), TU5 (BDY/BFZ/NFT/NFV/NFW/NFY/NFZ), TU5JP4 (NFU/NFX), XU7 (LFW/LFX/LFZ), XU7JP4 (LGY), XU10 (RFL/RFU/RFW/RFX/RGX/RGY), XU10JP4 (RGX/RGY), EW7J4 (RLZ), EW10A (RFJ), EW10J4S (RFK), EW10D (RLZ), EW12J4 (3FZ), ET3JE (KFU), TU3A/JP (KFV/KFW), DV4TD (8HW/8HX/8HZ), DV4TED4 (8HV/8HY), DV6ATED4 (9HX/9HY/9HZ), EW10-CVI (RLZ), EW12 (3FZ), DW8 (WJZ/WJY), DW10 (RHY/RHV/RHZ/RHS/RHM/RHW/RHT/RHR/RHX), DW12 (4HX/4HZ/4HW/4HY), EW7J4 (6FZ), EW10J4 (RFR), EW10J4D (RLZ)

**3- Contents**

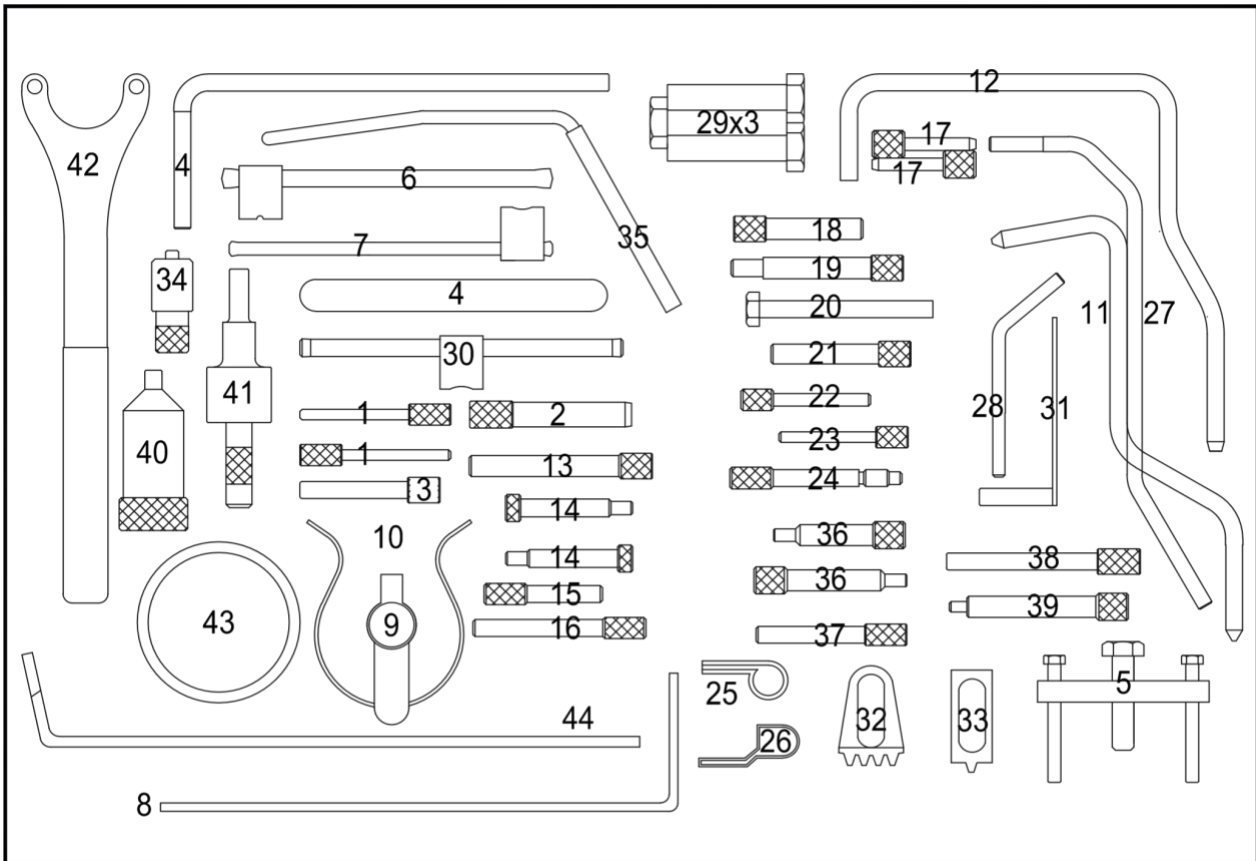

N°	Description	OEM Code
1	Crankshaft locking pin (x2)	0132-AB 0194-A
2	Crankshaft locking pin	0194-C 21-262 303-734
3	Crankshaft locking pin	0194-B
4	Flywheel locking pin + Tension spring	0188-X
5	Flywheel pulley puller	0188-P2 0188-P 174 7015-7
6	Tensioner pulley locking lever	0188-1
7	Tensioner pulley locking lever	0188-12
8	Tensioner pulley locking pin	0188-Q2
9	Tensioner pulley locking pin	0188-AH
10	Timing belt retaining clip	0132-AK 0188-AK 0189-K 0153-AK 4533-TAD MOT 1436

11	Flywheel locking pin	0153-N 0188-Y 7014-TJ 7099-TM 9797-34
12	Flywheel locking pin	0188-D 7017-TM
13	Crankshaft locking pin	4507-TB
14	Crankshaft locking pin (x2)	0153-AB 9041-TZ
15	Crankshaft locking pin	0132-AJ2 4533-TAC2
16	Crankshaft locking pin	0132-AJ1 0153G 0188-M 0189-J 4533-TAC1 5711-TA
17	Crankshaft locking pin (x2)	0153-AB 9041-TZ
18	Crankshaft locking pin	0132-R 7004-TG 7018-TY
19	Crankshaft locking pin	0189-A
20	Screw M8x80mm	0188-E
21	Crankshaft locking pin	0178-B 5711-TB
22	Crankshaft locking pin	0188-H
23	Crankshaft locking pin	4527-TS1
24	Crankshaft locking pin	4527-TS2
25	Tensioner pulley locking pin	4200-TH
26	Tensioner pulley locking pin	0117-AR
27	Flywheel locking pin	0153-U 7019-T
28	Flywheel locking pin	0132-Q 0132-QZ 4507-TA 9767-27
29	Screw M8	
30	Tensioning tool	0178-E
31	Flywheel locking pin	0132-X 0188-Q1 4507-TJ 9767-89
32	Flywheel locking tool	0153-A 6012-T 9765-54

33	Flywheel locking pin	013445. 0188-F 9004-T
34	Flywheel locking pin	0132-P 4507-TL
35	Flywheel locking pin	7017-TR
36	Flywheel locking pin (x2)	0153-M 0178-C 0178-D 7014-TM 9767-94
37	Flywheel locking pin	0189-B 21-163
38	Flywheel locking pin	0132-AJI 0153-G 0188-M 0189-J 4533-TAC1 5711-TA
39	Flywheel locking pin	0189-L
40	Flywheel locking pin	0189-C
41	Flywheel locking pin	0189-R
42	Pulley locking lever	0606-AI.A2
43	Tensioner pulley adjusting tool	0189-51
44	Tensioner pulley locking pin	0189-S2